

## EXCHANGE PROGRAM FACT SHEET 2022/2023

### Contact Information

<p><u>Main address:</u> 105 St. George Street International Programs &amp; Services, Room 209 Toronto, Ontario M5S 3E6 CANADA</p>	<p>Fax: +1 (416) 946-3945 Website: <a href="http://www.rotman.utoronto.ca">www.rotman.utoronto.ca</a></p>
<p><u>Contact:</u> Freeda Khan Assistant Director, Culture &amp; Community, International Lead</p>	<p>Tel: +1 (416) 978-3943 <a href="mailto:freeda.khan@rotman.utoronto.ca">freeda.khan@rotman.utoronto.ca</a></p>
<p><u>Contact:</u> Edith Cheung Program Coordinator, International Programs &amp; Services</p>	<p>Tel: +1 (416) 978-7955 <a href="mailto:edith.cheung@rotman.utoronto.ca">edith.cheung@rotman.utoronto.ca</a></p>

### General Information

Located in downtown Toronto and part of the University of Toronto, the Rotman School of Management is home to the leading MBA program in Canada. As well as Rotman being the top business school in Canada, the University of Toronto consistently ranks in the global Top 20, especially for our faculty and research.

The Rotman School offers a bold vision for business education that can't be found anywhere else. At Rotman, students will learn to go beyond the functional areas of business to consider the big picture, approaching each challenge with creativity and a willingness to take risks. Our innovative methodology will allow students to tackle the wicked problems of the modern economy

Toronto is the 4th largest city in North America and its 2nd largest centre for financial services and communications technology, the site of major clusters of innovation in industries ranging from aerospace to biotech. A city of neighbourhoods, it is one of the most culturally diverse places on earth, and its openness to the global economy make it a perfect spot to gain an international perspective on business. Known for its safe, clean streets and a vibrant culture, it's a great place to live and work. The Rotman School takes full advantage of its downtown location - just blocks from Bay Street - by drawing on a rich pool of business and political leaders as teachers, mentors and speakers.

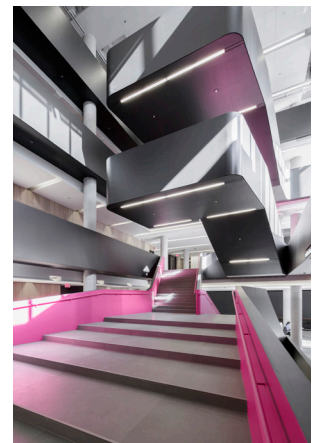
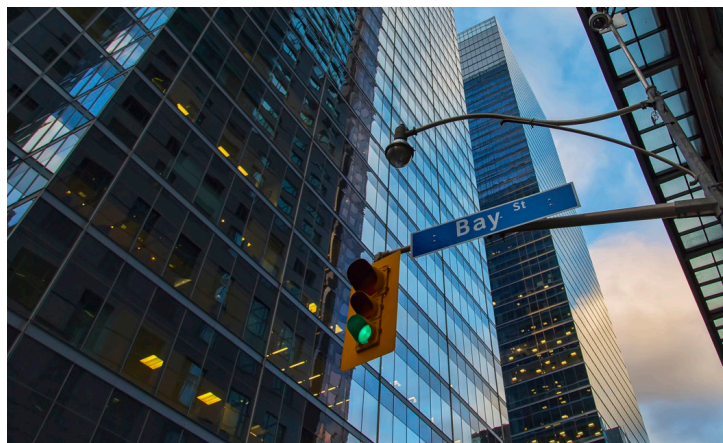

## Term Dates

Exchange students participate in the second year of the Full-Time MBA program and study on a full time basis for one full term (Fall or Spring).

FALL TERM	Course Selection Process	July 2022
	Arrival in Toronto	Late-August Recommended
	Exchange Student Orientation	September 7, 2022*
	Classes	September 12, 2022 to December 2, 2022*
	Examination Period	December 5-16, 2022*

SPRING TERM	Course Selection Process	Late September 2022
	Arrival in Toronto	Early to Mid-January recommended
	Winter Intensive Classes (optional, part of Spring term)	January 2-13, 2023*
	Exchange Student Orientation	Week of January 16, 2023 (exact date TBD)
	Classes	January 16, 2023 to April 7, 2023*
	Examination Period	April 10-21, 2023*

\*Tentative Dates

Note: All students are expected to complete exams during the scheduled examination period.

## Timelines

### Nomination from Partner University

An email nomination from the partner university by May 2, 2022\* for the Fall term and August 1, 2022\* for the Spring term

### Application Package from Students

Exchange students must submit their application package by May 20, 2022\* for the Fall term and August 19, 2022\* for the Spring term via email

### Course selection

Course registration: July 2022 (Fall term) and September/October 2022 (Winter Intensive & Spring term)

Course add/drop: July - September 2022 (Fall term), and October 2022 - January 2023 (Winter Intensive & Spring term)

\*Note: nominations and/or application packages received after the deadline may be accepted. Depending on the timing, the exchange student may miss out on the first round of course registration process.

## Exchange Process

- Home University to advise Rotman of exchange student nomination;
- Exchange student to submit Rotman Application Form, resume, cover letter and current academic transcript;
- Upon successful assessment and acceptance, student is enrolled into Rotman for one term;
- Nominated exchange students receive access to the Rotman Hub (student portal) and proceed with course selections;
- Orientation: All exchange students must attend the mandatory Exchange Orientation Day.

## Language Requirement

Letter or email from Home University confirming student's English language proficiency based on one of the following:

- Undergraduate or graduate degree from a recognized English language university;
- Minimum TOEFL iBT (internet based test) score of 100;
- Minimum IELTS score of 7.0.

\*Note: This requirement is waived for Native English speakers.

## Course Structure

Language of Instruction:	English																								
Program Size:	600 Two-Year (Full-time) Program Students, 300 Three-Year (Part-time) Program Students																								
Class Size:	15-40 students in second year elective courses																								
Course Load:	Minimum 1 elective course. Full-time course load is considered taking 4-5 courses*																								
Teaching Methods	Small seminar classes, involving lectures, case studies and project work; students are expected to participate in class discussions																								
Classes:	Classes generally meet once a week for 2 hours over 12 or 13 weeks in a term and each elective course is worth 24 or 26 contact hours																								
Grading:	<p>The Rotman School applies a relative grading system with letter grades, translating into a 4.0 Grade Point Average (GPA)</p> <table border="0"> <tr> <td>A+</td> <td>4</td> <td>Outstanding Performance</td> <td rowspan="7">Note: The GPA appears internally only and is stated on the Preliminary Grade Report. The student's GPA is not calculated nor stated on the official University of Toronto transcript.</td> </tr> <tr> <td>A</td> <td>4</td> <td>Superior Performance</td> </tr> <tr> <td>A-</td> <td>3.7</td> <td>Excellent Performance</td> </tr> <tr> <td>B+</td> <td>3.3</td> <td>Good Performance</td> </tr> <tr> <td>B</td> <td>3</td> <td>Average Performance</td> </tr> <tr> <td>B-</td> <td>2.7</td> <td>Minimum Acceptable Performance</td> </tr> <tr> <td>FZ</td> <td>0</td> <td>FAILURE: Less than Acceptable Performance</td> </tr> </table>			A+	4	Outstanding Performance	Note: The GPA appears internally only and is stated on the Preliminary Grade Report. The student's GPA is not calculated nor stated on the official University of Toronto transcript.	A	4	Superior Performance	A-	3.7	Excellent Performance	B+	3.3	Good Performance	B	3	Average Performance	B-	2.7	Minimum Acceptable Performance	FZ	0	FAILURE: Less than Acceptable Performance
A+	4	Outstanding Performance	Note: The GPA appears internally only and is stated on the Preliminary Grade Report. The student's GPA is not calculated nor stated on the official University of Toronto transcript.																						
A	4	Superior Performance																							
A-	3.7	Excellent Performance																							
B+	3.3	Good Performance																							
B	3	Average Performance																							
B-	2.7	Minimum Acceptable Performance																							
FZ	0	FAILURE: Less than Acceptable Performance																							

\* If 6 courses are required by the student's home university, please Coordinator, International Programs & Services

## Academic Areas & Specializations

The Rotman School offers over 40 electives each term; exchange students are eligible to take [courses offered](#) as part of the second year of the MBA program, subject to space availability. Details on course offerings will be sent to all nominated students.

Students are able to select courses from the following [Academic Areas](#):

Academic Areas:	Accounting	Human Resources Management/Organizational Behaviour
	Economic Analysis & Policy	Marketing
	Integrative Thinking	Operations Management & Statistics
	Finance	Strategy

Specializations currently offered include:	Brand Management	Human Resources Management
	Business Design	Innovation and Entrepreneurship
	Consulting	Investment Banking
	Financial Reporting and Analysis	Leadership and Change Management
	Funds Management	Process and Supply Chain Management
	Global Management	Real Estate
	Health Sector Management	Risk Management and Financial Engineering
	Management Analytics	Social Impact & Sustainability

## Computing Requirements

All Rotman MBA students are required to own a laptop computer. This enables all students to learn how to use technology in a business environment, effectively work on assignments and take advantage of our new initiatives (through Quercus, The Rotman Hub, and the wireless computer network). We strongly recommend that all exchange students either bring a laptop to Rotman or plan to purchase one upon arrival. All exchange students will receive free access to email and internal portals used at Rotman / University of Toronto for the duration of the exchange period. Please note: upon arrival and registration, all communications from the Rotman School will be via the Rotman/University of Toronto email address.

## Dress Code

MBA students tend to dress casually when attending classes; however, there are many networking opportunities at seminars, speaker series or receptions where a suit (business attire) would be more appropriate. Some courses also have a presentation component where business attire would be expected. We recommend that exchange students bring at least one business suit for these occasions.

## Career Centre

For international exchange students who may be interested in working in Canada, the Career Services at the Rotman School is happy to offer reciprocal career planning services to students from our partner universities. It is important to keep in mind, however, that the Canadian government requires non-domestic individuals to obtain work permits in order to legally work in Canada. To find out more about working in Canada, visit [Immigration, Refugees and Citizenship Canada \(IRCC\)](#).

## Estimated Cost of Living in Canadian dollars (for 4 months)

Accommodation	\$4,000 to 8,000
Food	\$1,300 to \$1,800
Books & Course Materials*	\$800
Transportation (local)	\$450
Required Health Insurance**	\$252
<b>TOTAL</b>	<b>\$6,802 to \$11,302</b>

\* All students are required to purchase electives course materials for any course that requires it (e.g. course package and/or textbooks).

\*\*Exchange students are required to purchase the University Health Insurance Plan (UHIP), which is approximately \$252 CDN per term. As UHIP only covers basic expenses, we strongly recommend students buy extended health care coverage before coming to U of T.

## Housing Availability

Rotman does not have its own student residence and so, exchange students are responsible for securing their own accommodation. While the University of Toronto has on-campus residence, due to the fact that demand exceeds supply, acceptance to the Rotman International Exchange Program does not guarantee a place in residence.

Exchange students are encouraged to independently explore the list options given (eg. [U of T Student Housing Services](#)). Incoming exchange students may also connect with Rotman outgoing exchange students for support and to see if accommodations can be swapped if exchange terms coincide. We highly recommend that exchange students begin the search for on or off-campus housing as soon as possible.

## Student Life

Getting involved is the best way to maximize the MBA experience. Rotman offers an array of opportunities to engage with the Rotman community and to broaden students' impact as a future leader. The best part of student life at Rotman is that it is largely organized and led by students, allowing individuals to hone their leadership skills and give back to the community.

The social, networking, and career-building activities centred around the student clubs at Rotman are an essential part of the MBA experience. Exchange students are strongly encouraged to explore the remarkable range and diversity of [student clubs](#) available in the Full-Time MBA program.

Each year, Rotman hosts over 100 public talks by international bestselling authors, top management executives and other influential thought leaders. These events provide students an unparalleled exposure to some of today's business leaders.



## Facilities

The University of Toronto has a comprehensive range of student services, including athletic facilities, international student support and centre ([CIE](#)), counselling and restaurants. The Rotman School provides a building access card, a Rotman e-mail address (for use while at the Rotman School), a Finance Trading Lab and Milt Harris Library that has extensive databases for research.

Enjoy this [virtual tour](#) of the Rotman School.

